

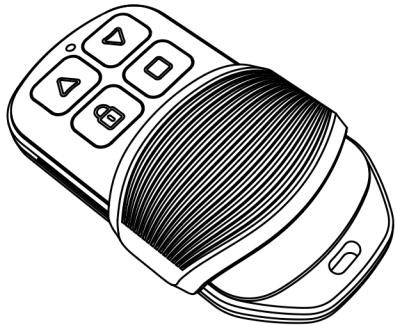

# GARAGE REMOTE User Manual

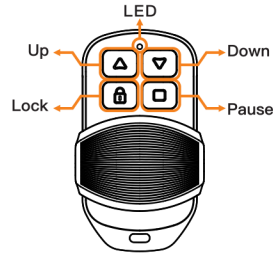

Xhorse garage remote is special design and easy to use for customers. Support remote cloning(remote clone from original remote), Set frequency, Delete code and Data recovery functions. Also support remote generation for variety of garage remote brands, frequency edition by VVDI KEY TOOL series devices.



### Check delete code status

Before remote cloning function, need to check the garage remote delete code status, make sure remote in deleted code status.

- Deleted code status: The LED will flashing once then go out quickly when keep pressing any button of the garage remote.
- Delete code operation:
  - Press and hold "Up" and "Down" of the garage remote (▲▼) at the same time, until LED light on. keep pressing 2 buttons until the LED light off, then release the button;
  - Press and hold "Pause" (⏸), until LED light on then off, then release the button, Delete code successful.

### Remote Cloning

- Preparation work before remote cloning
  - Please confirm the garage remote has been in deleted code status. if not, please do above delete code operation first.

② Make sure the garage remote frequency is same as original remote, in case the remote cloning failed or even remote cloning successful but the working distance too short, working not good occurred.

### 2. Remote cloning operation

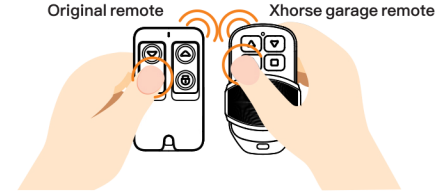

- Press and hold any one button of Xhorse garage remote, this remote will enter cloning mode, LED will flashing once then off.(keep pressing the button)
- Press and hold original remote one button(same button as step 1), Put the original remote next to Xhorse garage remote. Once the LED light on means current button cloning successful.
- Following above steps to remote cloning all buttons one by one.

### Set frequency

- Set frequency situation  
There are many different brands of garage remote in market, different manufactures maybe with different frequency. If the original remote and Xhorse garage remote frequency is different, it may caused remote cloning failed or even remote cloning successful but the working distance too short, working not good. Xhorse garage remote support set frequency function(20 frequency point) to ensure frequency same as original remote.
- Set frequency operation

- Enter set frequency mode:  
Press and hold the "Lock" and "Pause" buttons (🔒⏸) at this time, remote LED light on, keep pressing two buttons until the remote LED light off, then release the buttons.

- Set frequency :  
Press the "Up" button (▲), Press once, LED flashing once. For different frequency with different press times, please refer to following frequency reference table.
- Double check frequency :  
After set frequency successful, release all the buttons. Wait 5 seconds, remote LED will flashing, the flashing times depends on set frequency.(please refer to frequency reference table).
- Exit set frequency mode:  
After remote LED stop flashing, press the "Lock" and "Pause" button (🔒⏸) immediately, meanwhile the LED light on, keep pressing 2 buttons, until LED light off. then release the button, set frequency operation successful.

### 3. Frequency edition by device

If the remote frequency is not in the frequency reference table, VVDI KEY TOOL series device(VVDI KEY TOOL, VVDI MINI KEY TOOL, KEY TOOL MAX, or KEY TOOL PLUS) support to set frequency at random point. For example: use KEY TOOL MAX cloning 320.5MHz original remote Take KEY TOOL MAX as an example, copy 320.5MHz garage remote, and the operation steps are as follows:

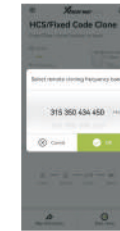

3.1 Enter KEY TOOL MAX HCS/Fixed Code Clone interface and select 320 frequency range;



3.2 Press the button of the original remote according to the device prompts;



Xhorse APP

Xhorse

DOWNLOADABLE FROM GOOGLE PLAY STORE AND APPLE APP STORE



All the information and illustrations in this document are for guidance only. Xhorse reserves the right to alter products designs, dimensions or info to improve the products quality. The contents of this document are fully protected by Copyright and may not be copied or reproduced in any form (e.g. mechanical, electronic, printing or video recording), without permission from Xhorse.



3.3 Edit the frequency that required;



3.4 Cloning the data. (If the original remote and cloning remote function code chasing occurred it can be solved by programming remote after the rolling code ID regeneration).

### Frequency reference table

Frequency point	Press times	Frequency point	Press times
315.00	1	310.00	12
350.00	2	311.00	13
430.00	3	313.00	14
431.00	4	315.50	15
432.00	5	330.00	16
433.00	6	350.05	17
433.82	7	370.00	18
433.92	8	430.50	19
434.00	9	433.70	20
434.42	10		
304.00	11		
		Other frequency	Set by Xhorse devices

Remark: Use vwdi keytool series device to generate garage remote from "Xhorse\_garage remote copy program" ( Garage remote->Xhorse\_garage remote copy program), and the remote can be set frequency as customer want ( Special function->VVDI remote function->Garage door key customization)

### Rolling code ID regeneration function

#### 1. Rolling code ID regeneration situation

### Rolling code ID regeneration function

#### 1. Rolling code ID regeneration situation

If the garage remote appears the code chasing phenomenon with original remote(original remote press button once and it works, the cloning remote need to press twice then it works meanwhile original remote not work), it can be solved by programing remote after the rolling code ID regeneration.

#### 2. Rolling code ID regeneration operation

- Enter the rolling code ID regeneration mode:  
Press and hold the "Up" and "Lock" buttons (▲🔒), the remote LED light on, keep pressing two buttons and LED light off;
- Regeneration of rolling code ID:  
Release the two buttons "Up" and "Lock" (▲🔒), then press and hold the "Pause" button (⏸), meanwhile LED light on, Keep pressing the button until remote LED light off, rolling code ID regeneration operations successful;

**Note:** The garage remote regenerated by rolling code ID can only be used after programing again. Need to find the learning button on the control box of the garage door, then operate the learning and matching procedures according to the instructions of the control box.

### Data recovery function

#### 1. Data recovery situation

When the garage remote is deleted code by mistake operation(garage remote in deleted code status), Data recovery function support recovery the code data from last time.

#### 2. Data recovery operation

Press and hold the two buttons "Down" and "Pause" (▼⏸) 3 seconds, remote LED light on, data recovery operation successful.

### Supplementary notes

The garage remote default built-in cloning program. The above five functions belong to cloning program function. If use device to generate the garage remote, the cloning program of the garage remote will be replaced. So need to rewrite the cloning program to restore cloning function by device.

### Support remote cloning or generation of garage remote brand list:

Kirin 350, Kirin 433, Linma 433, Anfusheng, Aonuo, Ostar 433, APRIMATIC, Anphosphorus 350, Anphosphorus 433, AnlinD 433, Anlin 580, Alcano A 315, Alcano B 433, Boda B Regeneration, Bohai, Bujin, Baisheng T18 433, Baisheng T19 433, Changshun, Changyuan Regeneration, Chibao A Blue, Changfeng 433, CELINSA 433, Dort B, DEA, DOORHAN 433, DEMA 433, Dooya DOOYA 433, ETDOR 433, E KA 433, ELKIABC 433, Fengye, Fubang, Ford, Fudi, Feiren, Gunde A GM, Guoweite, GBD, GAMEB, GAM, Haizhu A, Hengfuwei, Hongrsheng, Hongrsheng A, Hoss A, Hoss 433, Hoss C/D, Hoss F-325, Hoss F-330MG, Hoss F350MG, Hoss F-390, Shenyang Haitong, Haitong, Haomai, Jisu, Jisu A, Jiahe, Juguang 315, Juguang A 433, Juguang B Zaisheng, Gephos 350, Gephos 433, Jiuyi, Carson, Kaimenhong, Kema B, Kangma B, Kardin, KEY, Wright 680 regeneration, Wright red light regeneration, Wright green light regeneration, Ideal A Blue, LGUR 433, Mentor A, Mentor B, Master, Mentor, MOTORLINE, MH2004 433, MH2100N 433, ML-216H, Nanxiang regeneration, NICE SMLO, NICE\_FL01/2/4, Pan'an A, PROTECO, PAT1 433, Qianshan Second Generation, Ruineng A, Ruineng B, ROGER, RCG12C433, Sprite 60 S66, Sprite S80, Senma, Shengda, Shengtai B, Suoge, Suogesuoma KS680, Suoma A, Suoma B, Smart, Siwei A Red Light, General A, Tianhong A, Tianhong B, Tianhong C, Tianshan, Waikewei 433, Weston Regency, Xisaide 600, Xisaide 800, Xisaide B, Xisaide C, Sharp 315, Sharp 433, Xiangtian 350, Xiangtian 433, Yijie, Yide, Zhongtian A, and Zhongtian B600.

If there any brand not support remote cloning or generation, Xhorse will make update for garage remote program database in future

